

# Shower Linerizer

www.linerizer.com

Fits your standard (72" or taller)  
Shower Curtain Liner

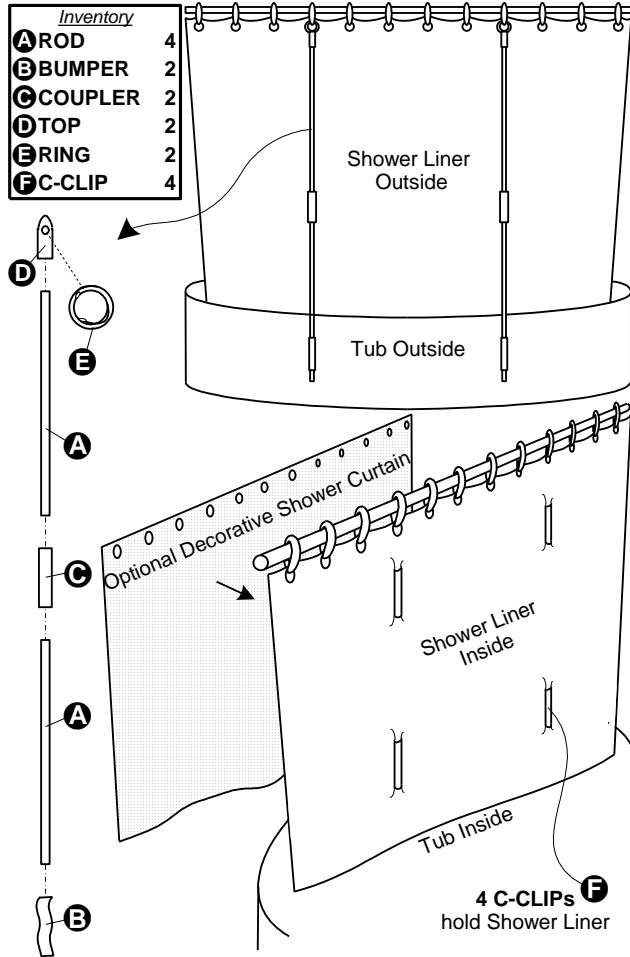

SEE INSTRUCTIONS OTHER SIDE

These steps already completed.

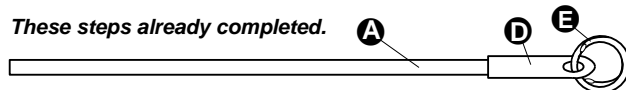

Thread **RING** through hole in **TOP**. Push **TOP** on first **ROD** up to hole so **RING** still moves freely in **TOP**. Repeat for second **ROD**.

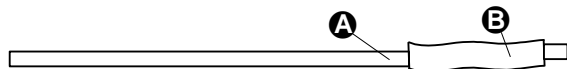

Put soft **BUMPER** onto third **ROD**. Repeat for fourth **ROD**. **BUMPER** inside has baking soda to help slide.

## INSTRUCTIONS

### ① CONNECT

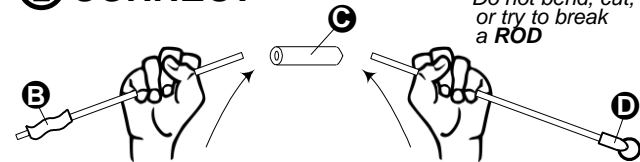

\* Do not bend, cut, or try to break a **ROD**

Use tight fitting **COUPLER** to connect first **ROD** (has **TOP**) to third **ROD** (has **BUMPER**) so **RODS** meet in middle. Repeat for second and fourth **RODS**. For easy connecting, place **COUPLER** in hot or boiling water 1 minute and instantly connect.

**Avoid bending COUPLER. COUPLER can be damaged.**

### ② HANG

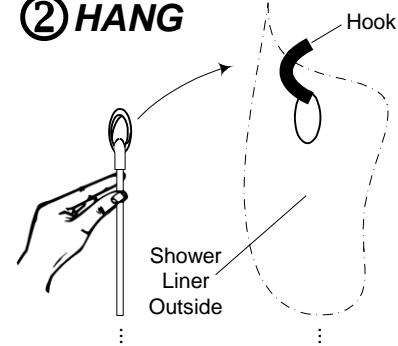

Spread Shower Liner fully as for shower use. Hang **LINERIZERS** on Shower Hook so **BUMPER** on outside of Tub, each about 1 foot from curtain rod end (e.g. Use 4th hook from right & left on 12 hook Shower Liner). Slide **BUMPER** to adjust for Tub contact.

### ③ CLIP

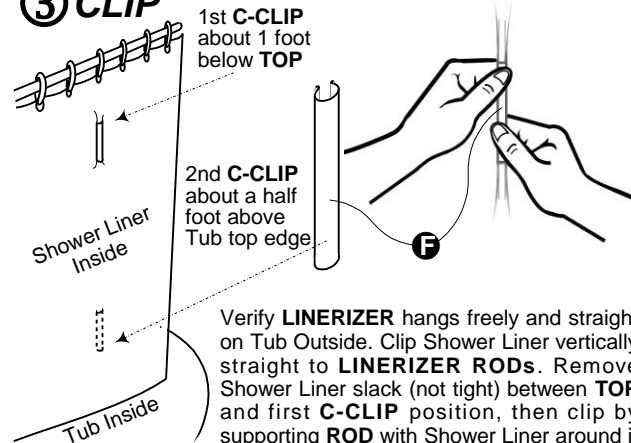

1st **C-CLIP** about 1 foot below **TOP**

2nd **C-CLIP** about a half foot above Tub top edge

Verify **LINERIZER** hangs freely and straight on Tub Outside. Clip Shower Liner vertically straight to **LINERIZER RODS**. Remove Shower Liner slack (not tight) between **TOP** and first **C-CLIP** position, then clip by supporting **ROD** with Shower Liner around it to press **C-CLIP** onto **ROD**. Similarly, clip second **C-CLIP** after removing slack between first **C-CLIP** and second **C-CLIP** position. Repeat for other **LINERIZER™**.

\* To remove **C-CLIP**: With care for Shower Liner, gently remove one end of **C-CLIP** from **ROD**

Hooks and clip spots may be selected for your unique setup and conditions. **Spread Shower Liner fully between Linerizers for use.**

U.S. Patent 10,555,644 and Patents Pending